

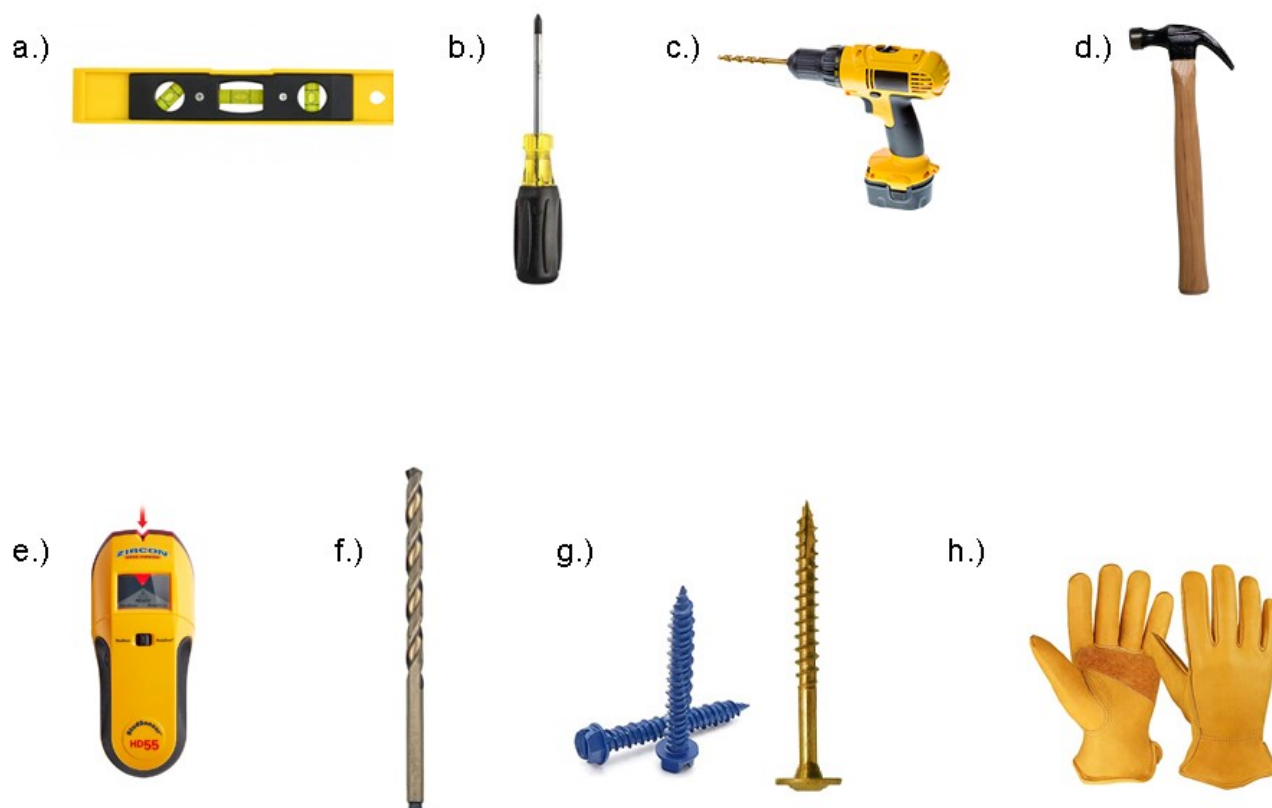

# Cabinet Installation Instructions

# Tools You Will Need Before Getting Started



- a. Level
- b. Screwdriver—For adjusting hinges and drawer fronts
- c. Screw gun (drill) with #2 Philips tip
- d. Hammer— For tapping the cams in
- e. Stud Finder (if attaching cabinets to a wood stud wall)
- f. Drill Bits— (see page 6 for more explanation)
  - 3/16" Drill bit used to pre-drill the sides of the cabinets when attaching cabinets together
  - 3/16" Drill bit used to pre-drill the back of the cabinets to attach the cabinet to the a wood stud wall
  - 1/4" Drill bit used to pre-drill the back of the cabinets to attach the cabinets to a cement wall
- g. Screws for mounting cabinets to the wall. (Note - The screws are not included because length and type of screws depend on the type of wall construction. See page 6 for more information)
- h. Working gloves—Melamine has very sharp edges and can cause cuts on the hands.

# Cabinet Hardware

**Cam and Dowel Hardware** is used in assembling every cabinet. This creates a strong joint that makes assembly easy.

Cams are used in tops, bottoms, and backs of cabinets which attach to the dowels that are used in the sides of the cabinets.



**KD-SYS6-F (Cam)**



**KD-SYS6-MS (Dowel)**



**HS-CLPPLT3**

## Hinge Mounting Plate

It attaches to the hinge side of cabinets to receive the hinge.



**HS-SC120R-HO**

## Standard Door Hinge

Clips into the hinge mounting plate after in-



**HS-SC-CRNR-45-200**

## Corner Cabinet Hinge

Used for angled corner cabinet doors. Uses the standard hinge mounting plate.



**MS-6X14ESCR**

## Euro Screw

These are used primarily for attaching drawer slides.



**1 1/2" Flat Head Screws**

These are used for attaching countertops and cabinet legs. Color may vary.



**MS-8MMX1.125WSCR**

## Drawer Front Screw

Drawer fronts come attached to the drawers with only 2 screws, after fronts are adjusted, these screws help keep the drawer front in place.



**MS-M4X45SCR-BA**

## Drawer Pull Long Screw

Used on 4" tall drawer boxes where the drawer box covers the holes for the pull.



**MS-BMPPR-03**

## Door/Drawer Bumpers

Bumpers are attached to doors and drawers to cushion the close.



**HS-SHLFPIN**

## Shelf Pins

These pins are used to support adjustable shelves.

# Start Here — Unpacking & Assembly Instructions

Making sure your cabinets arrive safely is extremely important, that is why we build crates around every job. The diagram below shows how we typically stack the parts in a crate. Larger orders may require (2) or more crates. If there are multiple crates the layers remain the same but may be separated into different crates.

**CAUTION: Corners of the melamine are sharp**

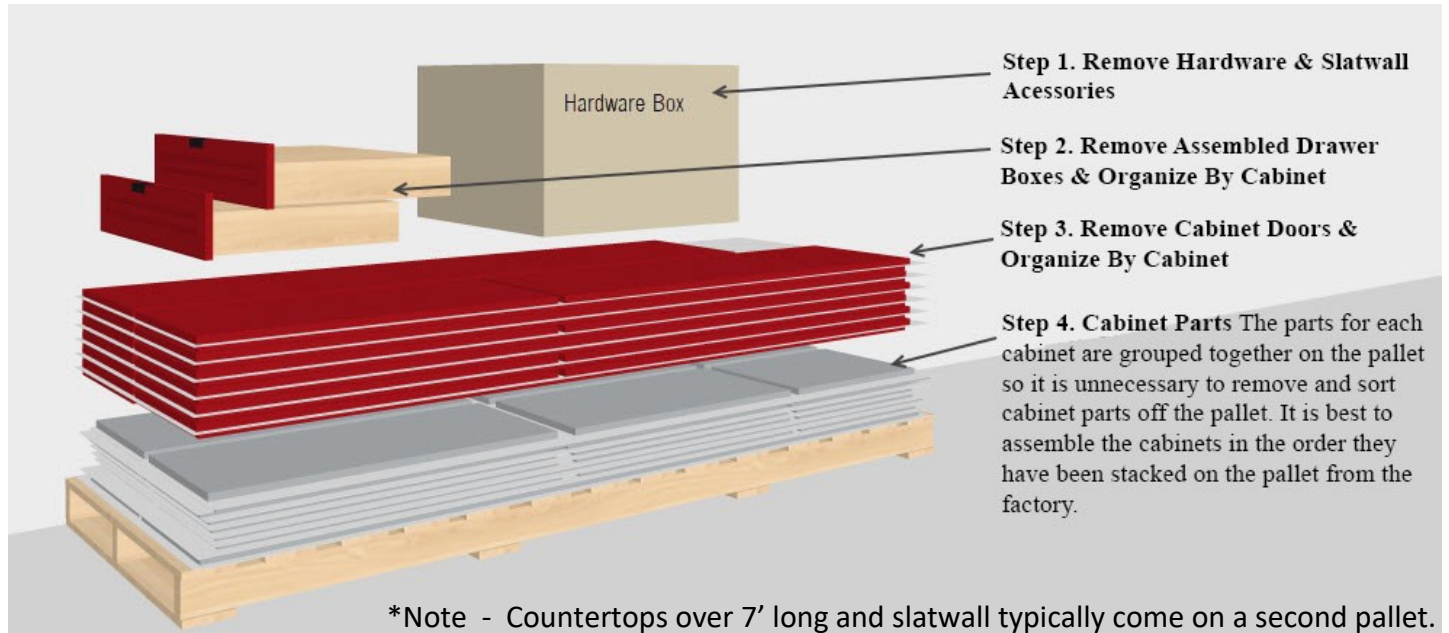

## Please Watch Assembly and Installation

[www.GarageCabinets.com/installation](http://www.GarageCabinets.com/installation)

Several videos are uploaded to our website to help with assembly and installation.





# Explanation of the Product Part List and the Part Labels

1. Every Cabinet (or Product) has a **Product Part List** W/exploded view drawing (like the one shown below). This document is specific to you and your order.



**Product Part List**  
 Greenberg Casework Co., Inc.

**Work Order: 30620 - GordonWS**  
**Project Name: Batch 10-28-20**  
**Room Name: 30620 - GordonWS**

Page 2 of 12  
 10/20/2020

**Product ID - 20.02**    **QTY - 1**    **WS-T1D**    **W 16.5in x H 75.12in x D 23.78in**

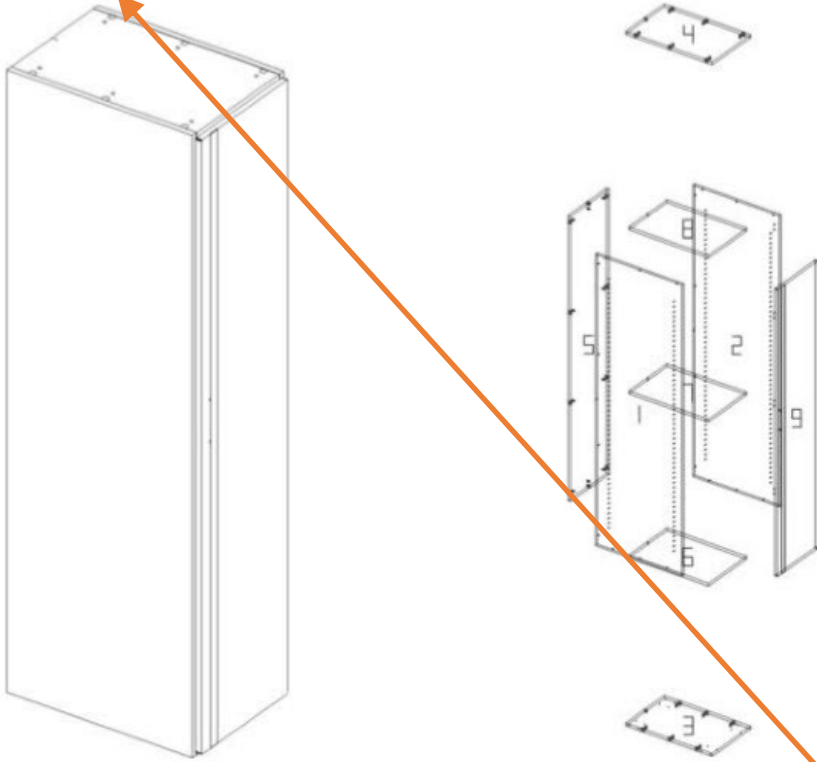

<u>Index</u>	<u>Part Name</u>	<u>Width</u>	<u>Length</u>	<u>Index</u>	<u>Part Name</u>	<u>Width</u>	<u>Length</u>
1	Tall Left Side	23.78 x 75.12		2	Tall Right Side	23.78 x 75.12	
3	Tall Bottom	23.78 x 15		4	Tall Top	23.78 x 15	
5	Tall Thick Back	15 x 73.58		6	Tall Adj Shelf	21.92 x 14.84	
7	Tall Adj Shelf	21.92 x 14.84		8	Tall Adj Shelf	21.92 x 14.84	
9	Door Tall Right	15.63 x 74.13					

2. Every cabinet part on the pallet has a label
- A. The part label references the **Product ID** the part goes to (See Orange Arrow)
  - B. The part label gives the part description that is referenced in the **Product Parts List** (See Blue Arrow)

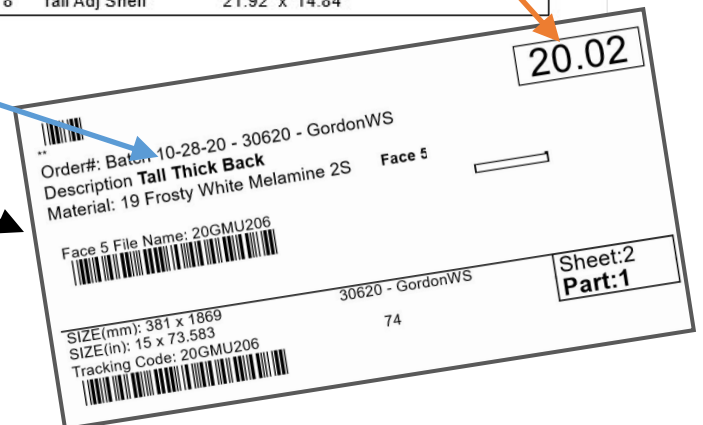

# 4 Important Assembly & Installation Notes

## 1. Cabinet Leg Installation

The leg base has chamfered corners that must extend over the side of the cabinet (as shown). The **thin tab** must be to the inside of the cabinet. The chamfered corner must face the outside.

Correct positioning of the chamfered corners is very important as incorrect installation can cause the cabinet to fail. Secure the leg base with the **1 1/2" Flat Head Screws**.

**If legs are installed correctly the cabinet will support several hundred pounds. If they are installed incorrectly, they will not and can cause failure.**

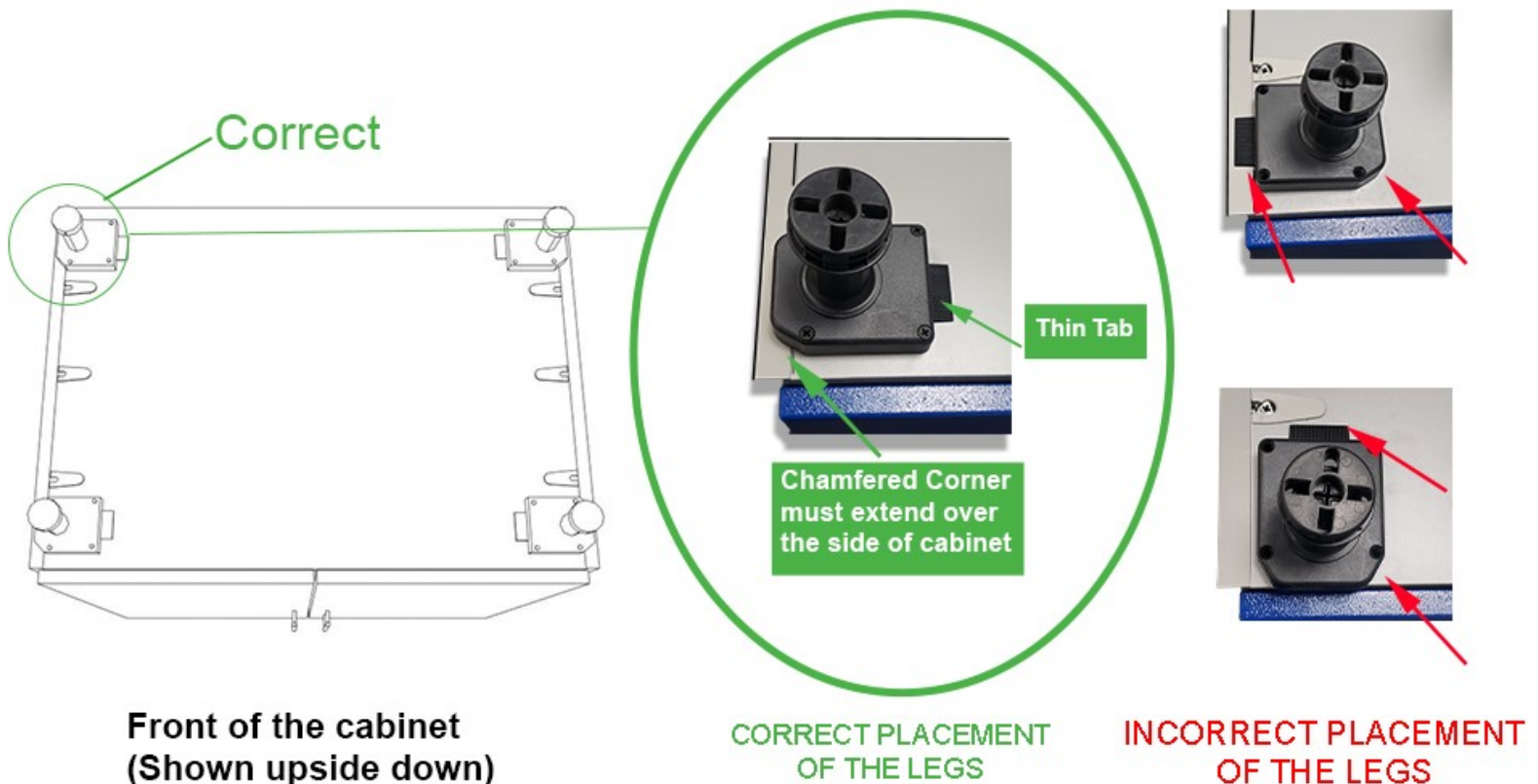

2. When assembling cabinets, it is important to not move the cabinet until the back is in it. This is especially important with tall cabinets. The back is what gives the cabinet the structure to keep from racking.

## Door Hinges - Adjustment

When installing hinges into the door turn the hinge cup screws 1/2 turn to secure the hinge to the door.

Once the door is hung on the cabinet the hinges will most likely need to be adjusted to get the door to fit properly. The hinges are 6 - way adjustable.

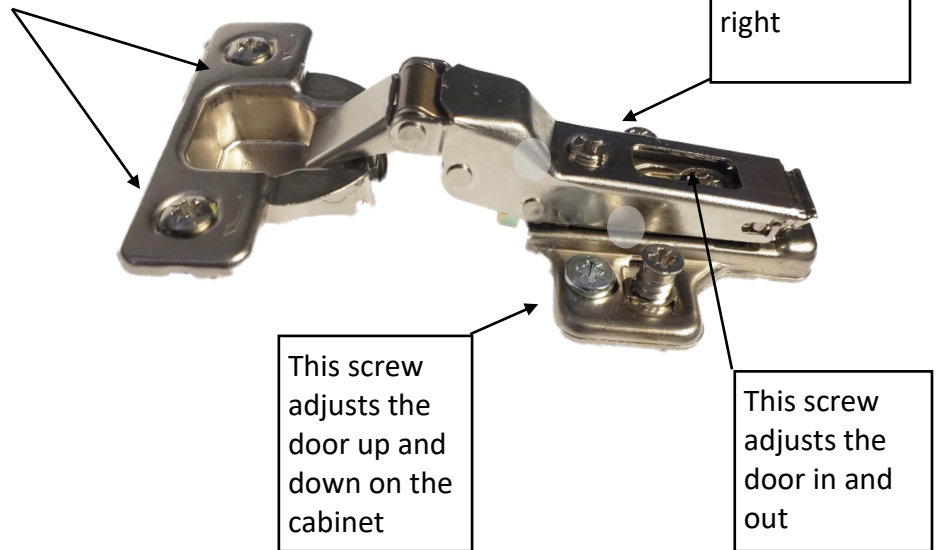

## 3. Screwing Cabinets To Each Other

We highly recommend the cabinets to be screwed together to avoid any movement or gaps between cabinets. We provide **MS-8MMX1.25WSCR Drawer Front Screw** to attach the cabinets. The screws should be placed in the front of the cabinets. One screw on the front top corner of the cabinet and one screw on the front bottom corner of the cabinet (as shown in the picture below).

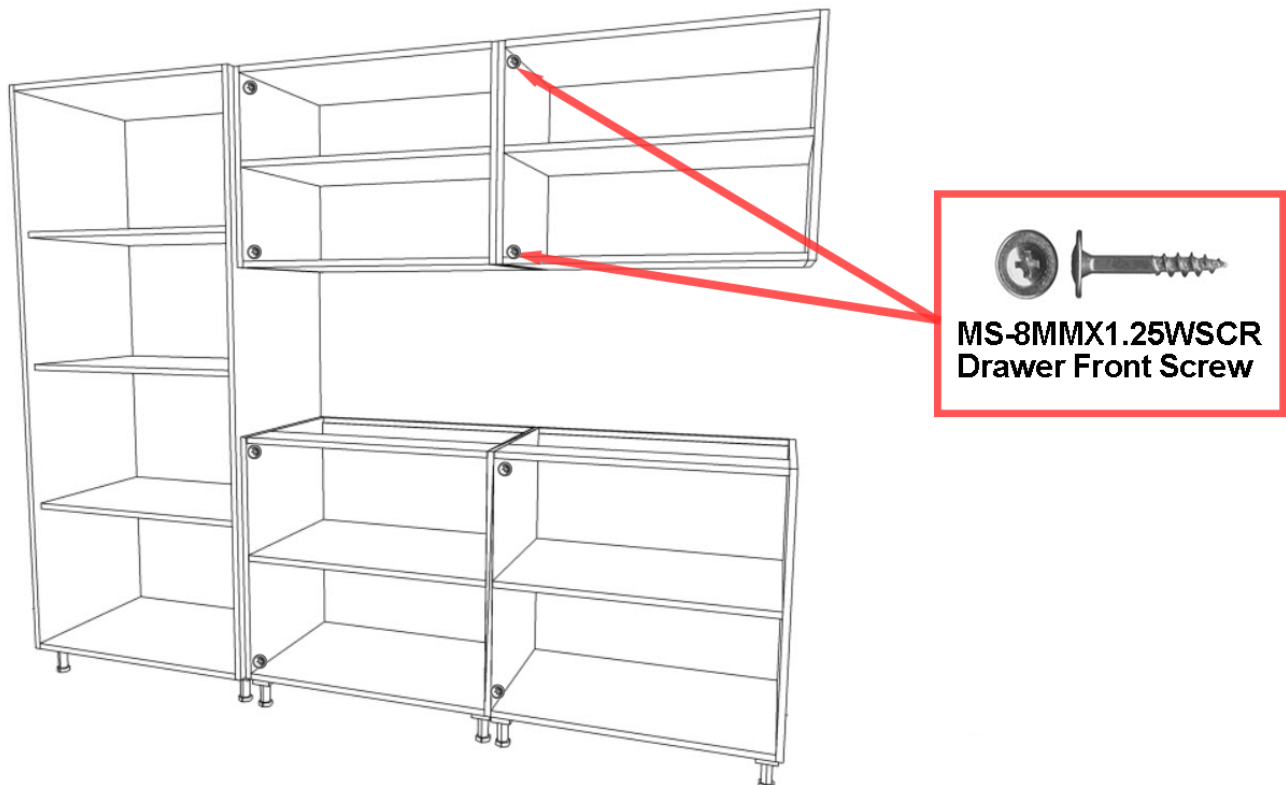

## 4. Screwing Cabinets To the Wall

As mentioned previously, cabinets should always be attached to the wall. The screws are not included because length and type of screws depend on the type of wall construction.

**If the wall construction is wood studs** and drywall we recommend Washer head or Wafer Head cabinet screws available at any of the home centers. The screw must go at least 1-1/4" into the wood stud (More is better and this dimension does not include any sheathing or drywall that may be over the studs, you must add extra length for sheathing). Keep in mind that there may be more than one layer of drywall on the wall, this is especially true for the wall between the garage and the house if the garage is attached. Code in many areas requires two layers of drywall to create a fire wall between the garage and the house. There are several suppliers of these screws such as GRK, Spax, Hillman, Fast-cap.



Typical walls have studs 16" on center, so we suggest that in each cabinet you have 2 screws in every stud, one at the top and one at the bottom. (For example: if your cabinet is 32" wide, you will have 2 studs to screw into for a total of 4 screws for that cabinet).

**If the wall construction is cement**, then use a hex head 1/4" TapCon brand masonry screw, making sure the screw goes into the concrete a minimum of 1-1/4". **(Note: Use a 5/16" nut driver rather than a Philips bit.)** You will need at least 4 screws per base or upper cabinet. Use 8 screws for a tall cabinet and space them evenly into vertical rows of 4. Attaching to concrete can be tricky. Be sure not to strip the screws when inserting them. A little lubricant on the screw, like WD-40, will help the screw go into the concrete.



## Adjusting Drawer Fronts

Drawer fronts come attached to the drawer boxes for ease of assembly. Once the cabinets are installed there is a small amount of adjustment built in to get them perfectly aligned.

There are two screws holding the drawer front on, to adjust the drawer front loosen the screws slightly and adjust the front and tighten again.

Once the drawer fronts are aligned there are additional drawer screws in the hardware box that need to be installed in order to keep the drawer front properly aligned.



**MS-8MMX1.125WSCR**  
**Drawer Front Screw**

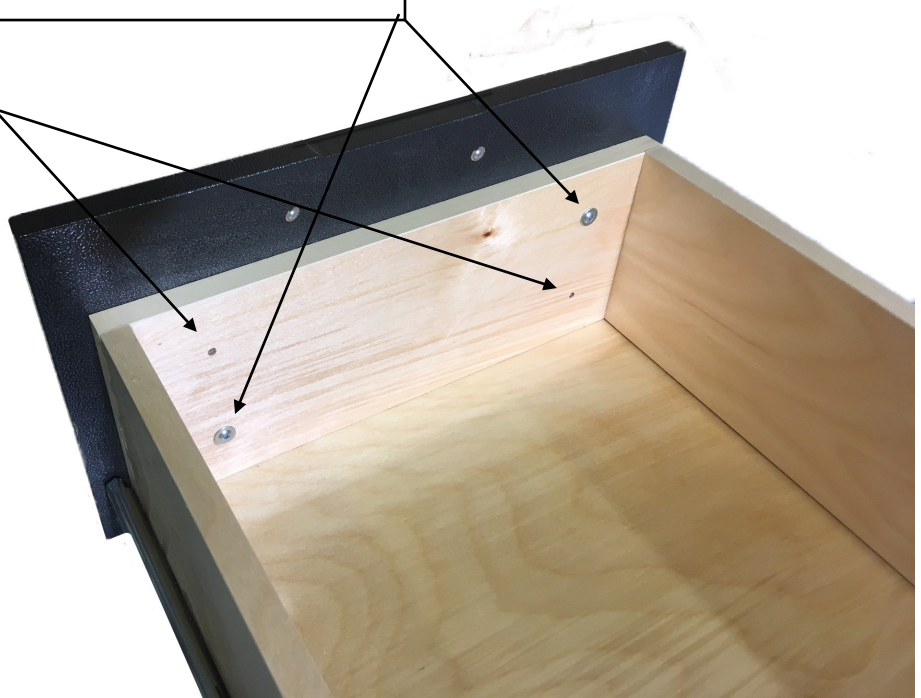

## Drawer Pulls on 4" Drawers

Once the drawers are aligned properly, the drawers box needs to be drilled out using a 3/16" bit, use the predrilled holes on the drawer front to drill through the drawer box. Then use the long drawer pull screws (shown below) to attach the drawer pull.



**MS-M4X45SCR-BA**  
**Drawer Pull Long Screw**

