

Unpacking & Assembly Instructions—Start Here

Crate Packing Explanation

Making sure your cabinets arrive safely is extremely important, that is why we build crates around every job. The diagram below shows how we typically stack the parts in a crate. Larger orders may require (2) or more crates. If there are multiple crates the layers remain the same but may be separated into different crates.

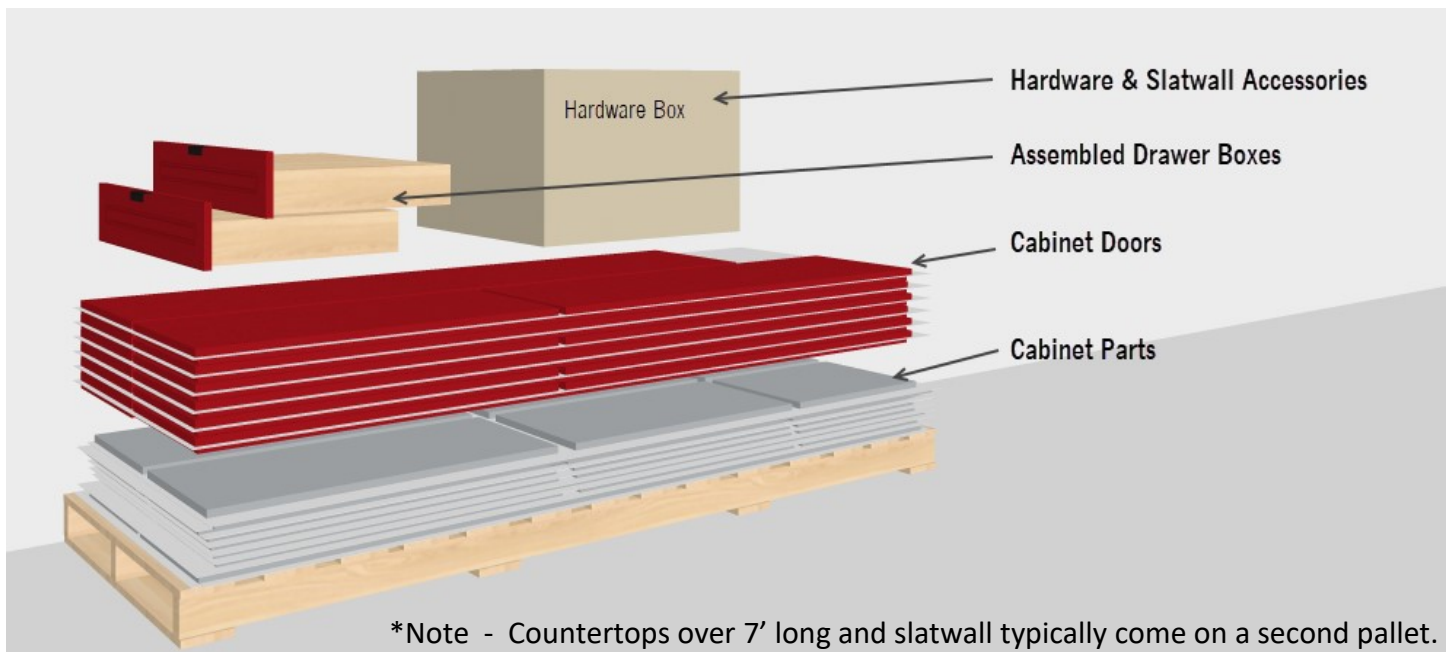

The parts for each cabinet are grouped together on the pallet so it is unnecessary to remove and sort cabinet parts off the pallet.

Assembly and Installation Videos

www.GarageCabinets.com/installation

Several videos are uploaded to our website to help with assembly and installation.



Explanation of the Product Part List and the Part Labels

1. Every Cabinet (or Product) has a **Product Part List** W/exploded view drawing (like the one shown below). This document is specific to you and your order.



GarageCabinets.com
DIRECT FROM THE MANUFACTURER

Product Part List
Greenberg Casework Co., Inc.

Work Order: WO11855A

Project Name: Redline WS Batch 06-26-19

Room Name: 25001 - McGilvra

Page 1 of 7

7/8/2019

Product ID - 1.01

QTY - 1

WS-T1D

W 16.5in x H 75.12in x D 23.78in

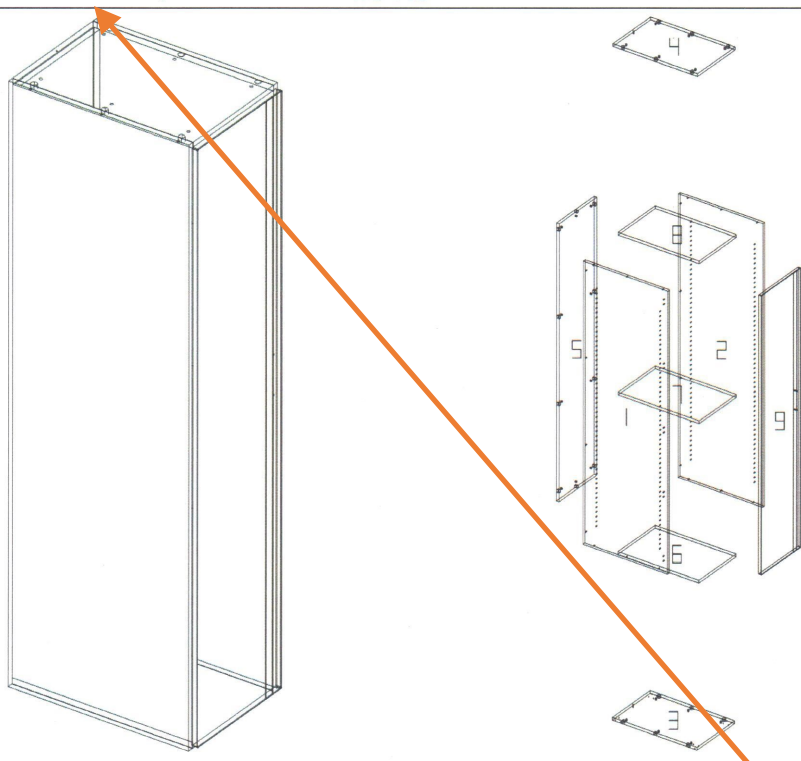

Index	Part Name	Width	Length	Index	Part Name	Width	Length
1	Tall Left Side	23.78	x 75.12	2	Tall Right Side	23.78	x 75.12
3	Tall Bottom	23.78	x 15	4	Tall Top	23.78	x 15
5	Tall Thick Back	15	x 73.62	6	Tall Adj Shelf	22.79	x 14.84
7	Tall Adj Shelf	22.79	x 14.84	8	Tall Adj Shelf	22.79	x 14.84
9	Door Tall Left	15.63	x 74.13				

2. Every cabinet part on the pallet has a label

- A. The part label references the **Product ID** the part goes to (See Orange Arrow)
- B. The part label gives the part description that is referenced in the **Product Parts List** (See Blue Arrow)

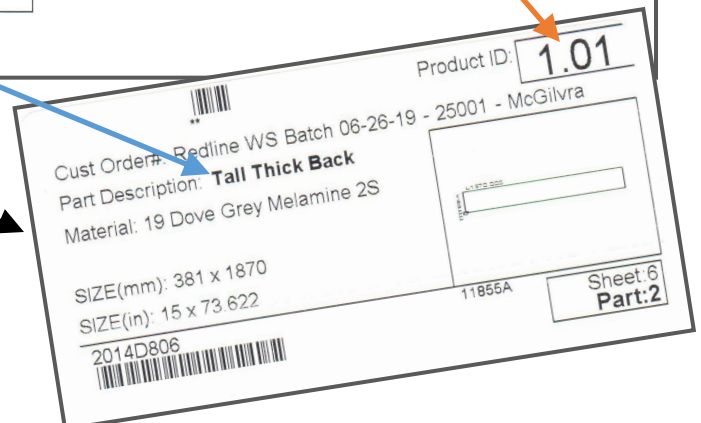

Cabinet Hardware

Cam and Dowel Hardware is used in assembling every cabinet. This creates a strong joint that makes assembly easy.

Cams are used in tops, bottoms, and backs of cabinets which attach to the dowels that are used in the sides of the cabinets.



KD-SYS6-F (Cam)



KD-SYS6-MS (Dowel)



HS-CLPPLT3

Hinge Mounting Plate

It attaches to the hinge side of cabinets to receive the hinge.



HS-SC120R-HO

Standard Door Hinge

Clips into the hinge mounting plate after in-



HS-SC-CRNR-45-200

Corner Cabinet Hinge

Used for angled corner cabinet doors. Uses the standard hinge mounting plate.



MS-6X14ESCR

Euro Screw

These are used primarily for attaching hinge mounting plates, drawer slides, and adjustable legs.



MS-6X14ESCR

1 1/2" Flat Head Screws

These are used for attaching countertops and backs of angled corner cabinets



MS-8MMX1.125WSCR

Drawer Front Screw

Drawer fronts come attached to the drawers with only 2 screws, after fronts are adjusted, these screws help keep the drawer front in place.



MS-M4X45SCR-BA

Drawer Pull Long Screw

Used on 4" tall drawer boxes where the drawer box covers the holes for the pull. (See explanation on the right)



MS-BMPPR-03

Door/Drawer Bumpers

Bumpers are attached to doors and drawers to cushion the close.



HS-SHLFPIN

Shelf Pins

These pins are used to support adjustable shelves.

Adjusting Drawer Fronts

Drawer fronts come attached to the drawer boxes for ease of assembly. Once the cabinets are installed there is a small amount of adjustment built in to get them perfectly aligned.

There are two screws holding the drawer front on, to adjust the drawer front loosen the screws slightly and adjust the front and tighten again.

Once the drawer fronts are aligned there are additional drawer screws in the hardware box that need to be installed in order to keep the drawer front properly aligned.



MS-8MMX1.125WSCR
Drawer Front Screw

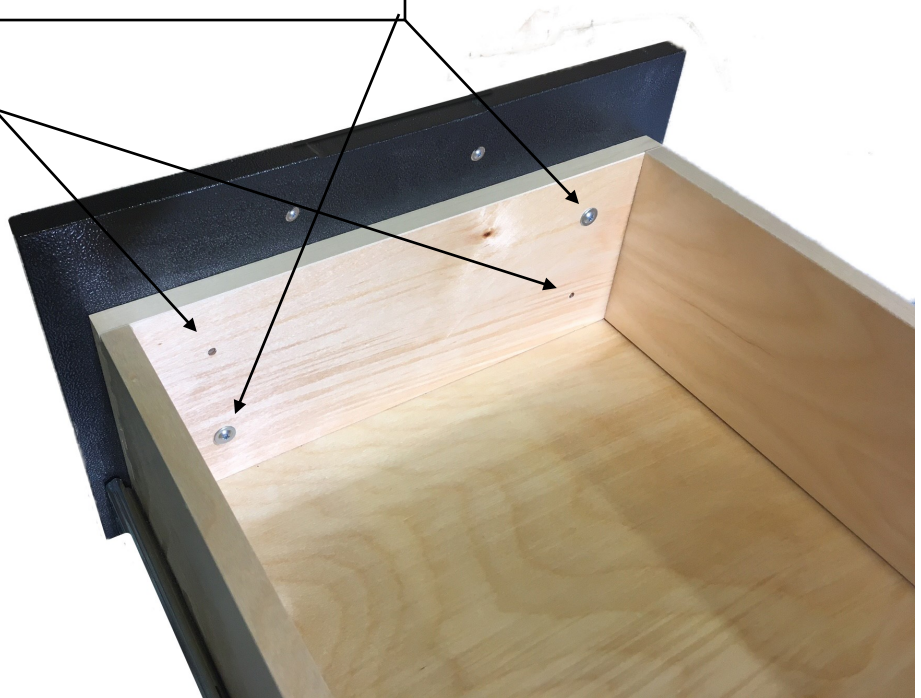

Drawer Pulls on 4" Drawers

Once the drawers are aligned properly, the drawers box needs to be drilled out using a 3/16" bit, use the predrilled holes on the drawer front to drill through the drawer box. Then use the long drawer pull screws (shown below) to attach the drawer pull.



MS-M4X45SCR-BA
Drawer Pull Long Screw



Door Hinges - Adjustment

When installing hinges into the door turn the hinge cup screws 1/2 turn to secure the hinge to the door.

Once the door is hung on the cabinet the hinges will most likely need to be adjusted to get the door to fit properly. The hinges are 6 - way adjustable.

